



Google Custom Search Search Like 4,569 people like this.

- Home, News, ArchShowcase, Events, Tutorials, Jobs, Catalog, Videos, Downloads, Blogs, Forums, Books, RSS, Advertise

The Smartest Free Lunch You Ever Accepted Just contact us to schedule your "Lunch and Learn" today!



BPM SELECT The Premier Building Product Search Engine bpmselect.com

AECCAFÉ Blogs the latest posts on the AEC Industry

« Strømbu Service Centre and Rest Area in Folldal, Norway by Carl-Viggo Hølmebakk BON in Bucharest, Romania by Corvin Cristian »

ArchShowcase



Sanjay Gangal Sanjay Gangal is the V.P. of Sales and Marketing at IBSystems, the parent company of AECCafe.com and GISCafe.Com. He has been following the AEC & GIS Industries for last 15 years. He has interviewed hundreds of AEC & GIS Executives over the years.

"Yona on the Beach" in Rockaway, New York by Stephen Yablon Architect

July 20th, 2013 by Sanjay Gangal

Like 2 Tweet 0 Share +1 0

Article source: Stephen Yablon Architect

In response to the MoMA PS1 Rockaway Call for Ideas, Stephen Yablon Architect's "Yona on the Beach," which was one of the selected entries, accepts the inherent and increasingly dynamic weather conditions of barrier islands. SYA's idea is a new model for barrier island settlements; entire beach neighborhoods are raised high above the 100 year flood plain so that the barrier island below can naturally shift and change during storms with minimal impact to human habitation.



Image Courtesy © Stephen Yablon Architect

- Architects: Stephen Yablon Architect
Project: "Yona on the Beach"
Location: Rockaway, New York

Back to 'AECCafe Blogs' ArchShow case

Search

Submit Your Project Submit

Subscribe to AECCafe

- email, Facebook, Twitter, RSS Feed

Subscribe to this Blog

Join 109 other subscribers

Email Address

Subscribe

Archives

Select Month

Posts by date

July 2013 calendar grid showing days 1 through 31.

< Jun Aug >

Popular Posts This Month

- Madura House at Kiribathgoda in Sri Lanka by Damith... (1,294 views)
North Carolina Central University's Childley North Residence... (944 views)
Casa in Puglia, Italy by Peter Pichler (666 views)
MariSol Malibu Beach House in California by Berkus Design... (500 views)
Frøyland Orstad Church in Norway by LINK arkitektur (349 views)
D1 Canopy Design in Dubai creek, UAE by Innovarchi (228 views)
JNC Sales Office & Community Arts Center in Xiamen,... (131 views)
National Maritime Museum in Tianjin, China by Cox Rayner... (130 views)
Park Place in Mayfair, London by SHH Architects (128 views)
RELIGIOUS BOOKSHOP



- Team: Stephen Yablon, Pearl Kang, Rossitsa Kirilova, John Hsu, Dirk Pause
- Year: 2013



Image Courtesy © Stephen Yablon Architect

This idea was inspired by the visionary raised cities proposed by architects in Europe and Japan in the 1960's. The scheme is essentially similar to an offshore oil platform, supported by open steel truss columns housing stairs and elevators (which could be raised up in the event of a severe storm). Houses and commercial buildings would be modular prefabricated structures which could be lifted and installed on the platforms using cranes.



Image Courtesy © Stephen Yablon Architect

To reduce infrastructure and prevent debris and toxic waste during storms, cars would be parked in a nearby mainland parking lot. Monorails would connect the parking lot to the platform. People would circulate on the platform by walking or cycling on wooden walkways. Wood-decked public spaces surround large openings in the platform which, along with the open steel structure of the platform, allow abundant light to filter below. This is a critical element of the design as the success of the entire scheme depends on creating a pleasant experience at the beach level.

[PAULUS in Lisboa, Baixa by Site...](#) - (122 views)

Popular Posts (All Time)

- » [Madura House at Kiribathgoda in Sri Lanka by Damith Premathilake designed using SketchUp](#) - (17,094 views)
- » [Dongdaemun Design Park and Plaza, Seoul, Korea by Zaha Hadid Architects](#) - (15,192 views)
- » [JNC Sales Office & Community Arts Center in Xiamen, China by Line and Space, LLC](#) - (9,772 views)
- » [MariSol Malibu Beach House in California by Berkus Design Studio](#) - (6,704 views)
- » [The Park Hotel in Hyderabad designed by Skidmore, Owings & Merrill opens](#) - (5,748 views)
- » [Herma Parking Building in Gyonggi-Do, Korea by JOHO Architecture](#) - (3,830 views)
- » [London Aquatic Centre in London, UK by Zaha Hadid Architects](#) - (3,544 views)
- » [Steckelhörn 11 in Hamburg, Germany by J. Mayer H. Architects](#) - (3,456 views)

Recent Posts

- » [BES pavilion in Ha Tinh, Vietnam by H&P Architects](#)
- » [Pure White Seamless Freshwater Mother of Pearl Mosaics at China Hotel Complex in Poyang Lake by ShellShock Designs](#)
- » [AA HOUSE in Almería, Spain by MVN Arquitectos](#)
- » [Hakko Kyoto in Osaka, Japan by Osamu Morishita Architects & Associates](#)
- » [Nuovi spazi espositivi Fondazione Cini onlus by Cattaruzza e Millosevich Architetti Associati](#)
- » [GP practice by LENS°ASS ARCHITECTEN](#)
- » [supperclub Dubai in The Palm Jumeirah, United Arab Emirates by concrete](#)
- » [AP House by MVN Arquitectos](#)

Recent Comments

- » [Paul McAnearny Architects on Faceted House 2 in London, United Kingdom](#) by Paul McAnearny Architects Ltd
- » [Chris Mardiano on Samrode Building in Ventspils, Latvia](#) by Kristis Karklins Design and Arhitektūras Birojs FORMA
- » [@bunkerarq on Upcycling Pavilion in Mexico City](#) by BNKR Arquitectura
- » [@Esteban__Suarez on Upcycling Pavilion in Mexico City](#) by BNKR Arquitectura
- » [@AGi_architects on Kuwait Children's Hospital in Kuwait City](#) by AGi architects

Archives

Select Month

Tags

- [Amsterdam](#) [Argentina](#) [Australia](#) [Austria](#) [Barcelona](#) [Belgium](#) [Brazil](#) [California](#) [Canada](#) [China](#) [Czech Republic](#) [Denmark](#) [England](#) [France](#) [Germany](#) [India](#) [Israel](#) [Italy](#) [Japan](#) [London](#) [Los Angeles](#)



Career Opportunity
Senior Sales Consultant
IMSI DESIGN
Novato, CA

CADalog.com
Bluebeam



Image Courtesy © Stephen Yablon Architect

Emergency evacuation is an important consideration in the design. When evacuation is necessary, elevators or smaller public hoists scattered throughout would be used to lift all beach equipment (bicycles, surfboards, umbrellas, etc.) up into the houses. The inhabitants would then take a small vehicle or monorail to the parking decks and drive away from the incoming storm.



Image Courtesy © Stephen Yablon Architect



- Madrid Mexico
- City Netherlands New York Norway Paris
- Poland Portugal Russia
- Shanghai Slovenia South Korea Spain Sweden
- Switzerland Taiwan
- Texas The Netherlands
- Tokyo UK USA Vienna
- Washington

Categories

- » 3D Athletics Track (3)
- » 3D Studio VIZ (7)
- » 3D Waterfalls (1)
- » Activity Center (2)
- » Agriculture (1)
- » Airport (25)
- » Amphitheater (2)
- » Animal Shelter (1)
- » Apartments (216)
- » Aquarium (4)
- » Aquatic Centre (1)
- » Architectural Desktop (23)
- » Arena (2)
- » Arkey (3)
- » Art Center (13)
- » Art Gallery (40)
- » Art Studio (34)
- » Artificial Rock (1)
- » Athletic (1)
- » Atrium (1)
- » Auditorium (13)
- » Automatic Space (1)
- » Automobile (4)
- » Awards (16)
- » Bakery (4)
- » Bank (8)
- » Banquet (1)
- » Bar (54)
- » Barn (2)
- » Bathhouse (5)
- » Beach House (6)
- » Beauty Parlor (4)
- » Boat Dock (1)
- » Boat House (5)
- » Boiler House (1)
- » Boutique (14)
- » Box (2)
- » Bridge (46)
- » Broadcasting Company (2)
- » Building (533)
- » Building Campus (28)
- » Bus Terminal (5)
- » Business Centre (16)
- » Cabana (1)
- » Cabin (5)
- » Cafe (30)
- » Cafeteria (10)
- » Camp (7)
- » Campus (21)
- » Cancer Center (4)
- » Care Center (21)
- » carve (1)
- » Casino (1)
- » Castle (1)
- » Cave (2)
- » Cemetery (3)
- » Center (7)
- » Central hall (2)
- » Chamber (1)
- » Chapel (12)
- » Checkpoint (1)
- » Chess Academy (1)
- » Child Care (13)
- » Church (53)
- » Cinema (2)
- » City (24)
- » City Center (57)
- » Civic Center (14)

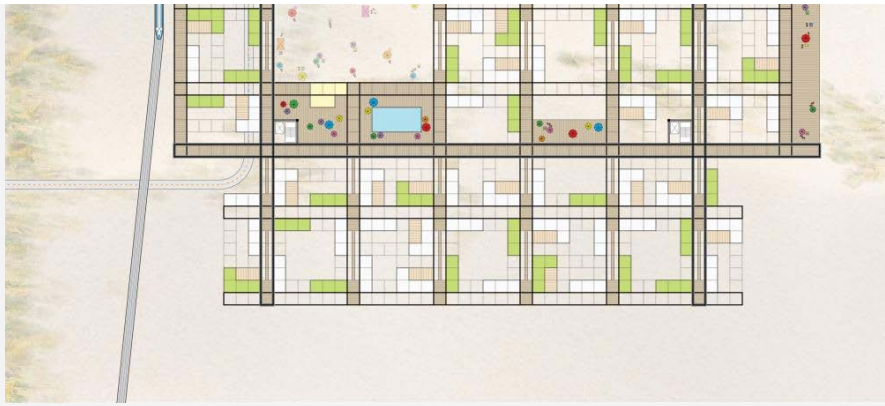

Image Courtesy © Stephen Yablon Architect

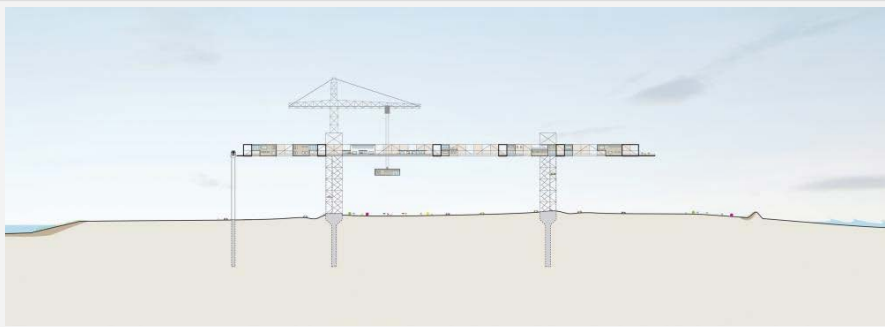

Image Courtesy © Stephen Yablon Architect



Image Courtesy © Stephen Yablon Architect



Image Courtesy © Stephen Yablon Architect



Image Courtesy © Stephen Yablon Architect

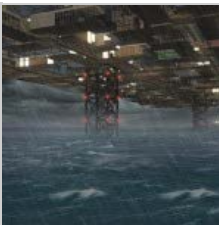

Image Courtesy © Stephen Yablon Architect



Image Courtesy © Stephen Yablon Architect



Image Courtesy © Stephen Yablon Architect

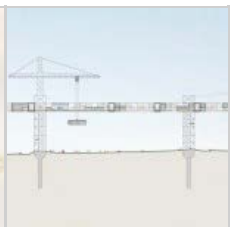

Image Courtesy © Stephen Yablon Architect

Related posts:



Richard Chai Store in New York by Snarkitecture



Museum of the Moving Image in Astoria, New York by Leeser Architecture

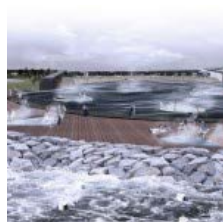

'Recon-Figure' FARROC Competition Entry in Far Rockaway, NY The Open Workshop

- » Clinic (16)
- » Club House (26)
- » Coffee machine (2)
- » College (11)
- » Commercial Building (127)
- » Community Centre (55)
- » Competitions (18)
- » complex (14)
- » Concert hall (19)
- » Conference Center (14)
- » Control Centre (4)
- » Convention Center (8)
- » Cooking (1)
- » Corporate Center (8)
- » Corridor (1)
- » Cottage (16)
- » Courthouse (8)
- » Courtyard (6)
- » craft objects (1)
- » Creation Centre (1)
- » Crematorium (3)
- » Cruise Port (5)
- » Cruise Terminal & Port Service Center (8)
- » Cultural Center (127)
- » Dance Center (2)
- » Day Centre (2)
- » Dental office (9)
- » Design Fair (1)
- » Detention Center (1)
- » development (2)
- » Diamond Exchange Center (1)
- » Digital Project (3)
- » Disaster Prevention Station (7)
- » Display (2)
- » EASY Membrane (1)
- » Eco-Center (11)
- » Educational and Business

Center (18)

- » Educational Center (101)
- » Educational Institute (40)
- » Electricity Center (1)
- » Elementary School (4)
- » Embassy (3)
- » Energetic Energy (1)
- » Energy plant (19)
- » Entance (1)
- » Entertainment Centre (14)
- » Equipement (1)
- » Event space (1)
- » Exhibition (2)
- » Exhibition Center (65)
- » Exhibition gallery (1)
- » Experience Centre (1)
- » Extention (2)
- » Facade (2)
- » Factory (24)
- » Farm House (16)
- » Fashion House (2)
- » Featured Architects (99)
 - » Frank Gehry (4)
 - » Henning Larsen (31)
 - » Peter Zumthor (4)
 - » Zaha Hadid (60)
- » Festival Of Landscape (1)
- » Filmtheater (2)
- » Financial Center (1)
- » Fire Station (11)
- » Fisherman's House (1)
- » Fitness center (4)
- » Flats (2)
- » Foodcourt (4)
- » Footbridge (9)
- » Forest (2)
- » Fort (1)
- » Fountain (1)
- » Fryender (1)
- » fuels station (1)
- » Funeral Home (3)
- » Furniture (9)
- » Furniture Mall (5)
 - » Artificial Furniture (2)
- » Gallery (42)
- » Garage (8)
- » Garden (55)
- » Gas Station (1)
- » Geometry Concept (1)
- » Golf Club (4)

Contact [Stephen Yablon Architect](#)

Tags: [New York, Rockaway](#)

This entry was posted on Saturday, July 20th, 2013 at 7:21 am and is filed under [Beach House](#). You can follow any responses to this entry through the [RSS 2.0](#) feed. You can [leave a response](#), or [trackback](#) from your own site.

Profile

[Sign in with Twitter](#) [Sign in with Facebook](#)

or

Name

Email Not published

Website



CAPTCHA Code *

Comment

Notify me of follow-up comments by email.

Notify me of new posts by email.

Notify me of follow-up comments via e-mail

- » [Golf Course](#) (1)
- » [Government Building](#) (19)
- » [Grasshopper](#) (44)
- » [Guest House](#) (10)
- » [gym](#) (3)
- » [Gymnastics Centre](#) (8)
- » [Hairstyling Center](#) (4)
- » [Hall](#) (4)
- » [Harbour](#) (3)
- » [Headquarters](#) (97)
- » [Health Center](#) (4)
- » [Health Research centre](#) (9)
- » [Hill House](#) (1)
- » [Historic Site](#) (7)
- » [holiday home](#) (2)
- » [Horse Riding facility](#) (2)
- » [Horse Stable](#) (1)
- » [Hospital](#) (54)
- » [Hospitality](#) (9)
- » [Hostel](#) (11)
- » [Hot House](#) (1)
- » [Hotel](#) (157)
- » [House](#) (1524)
 - » [Bathroom](#) (5)
 - » [Living Area](#) (3)
- » [House for disabled](#) (4)
- » [Houseboat](#) (2)
- » [Housing Development](#) (130)
- » [Hunting Lodge](#) (1)
- » [Hut](#) (7)
- » [Hydroelectric](#) (1)
- » [Industrial](#) (14)
- » [Information Tower](#) (6)
- » [Infrastructure](#) (13)
- » [Installation](#) (2)
- » [Institute](#) (6)
- » [Interiors](#) (40)
- » [Kerkythea](#) (1)
- » [Kindergarten](#) (38)
- » [Kitchen](#) (9)
- » [Laboratory](#) (2)
- » [Laboratory and Office](#) (19)
- » [Lake](#) (3)
- » [Land Preserve](#) (4)
- » [Landscape](#) (49)
- » [Landscapes](#) (3)
- » [LAW CENTER](#) (1)
- » [Learning Studio](#) (1)
- » [Library](#) (88)
- » [Light](#) (4)
- » [Light Rail](#) (1)
- » [LightHouse](#) (8)
- » [Lightroom](#) (2)
- » [Lightwave](#) (5)
- » [Lobby](#) (2)
- » [Locker Room](#) (1)
- » [Lodge](#) (4)
- » [Logistics Centre](#) (2)
- » [Lounge](#) (11)
- » [Main Street](#) (1)
- » [Mall](#) (6)
- » [Mansion](#) (1)
- » [Market](#) (10)
- » [Master Plan](#) (35)
- » [Media Centre](#) (9)
- » [Medical Center](#) (32)
- » [Medical production unit](#) (1)
- » [Meditation center](#) (2)
- » [Meeting House](#) (1)
- » [Memorial](#) (12)
- » [Metro Station](#) (4)
- » [Mine](#) (1)
- » [Mining town](#) (1)
- » [Mirror Stand](#) (1)
- » [Mixed use](#) (169)
- » [Mobile Cottage](#) (1)
- » [Mobile House](#) (1)
- » [Model](#) (1)
- » [module](#) (2)
- » [Monument](#) (1)
- » [Mosque](#) (5)
- » [Multimedia](#) (1)
- » [Multipurpose Hall](#) (5)
- » [Municipality](#) (1)
- » [Museum](#) (221)
- » [Music Centre](#) (24)
- » [Music College](#) (3)
- » [Music Hall](#) (8)
- » [National Monument](#) (5)

- » [Newforma](#) (1)
- » [Night Club](#) (1)
- » [Nursery](#) (1)
- » [Nursing Home](#) (4)
- » [office Complex](#) (25)
- » [Office Individual Building](#) (2)
- » [Office space](#) (10)
- » [Offices](#) (286)
- » [Oil Stations](#) (1)
- » [Oosterheem care centre](#) (1)
- » [Open Air Theatre](#) (1)
- » [Opera House](#) (18)
- » [Optical](#) (2)
- » [Outdoor](#) (1)
- » [Palace](#) (1)
- » [Park](#) (54)
- » [Parking](#) (2)
- » [Parking Structure](#) (15)
- » [Party Venue](#) (3)
- » [Pastry Shop](#) (1)
- » [Pavilion](#) (119)
- » [Penthouses](#) (1)
- » [Performing Arts Center](#) (17)
- » [Petrol Station](#) (2)
- » [pharmaceutical cultural](#) (1)
- » [Pharmaceutical Plant](#) (1)
- » [Pharmacy](#) (2)
- » [Pilgrim Centre](#) (1)
- » [Planetarium](#) (2)
- » [Plant](#) (9)
- » [Platform](#) (3)
- » [Playground](#) (6)
- » [Plaza](#) (9)
- » [Police Station](#) (8)
- » [Pool House](#) (11)
- » [Port's public spaces](#) (21)
- » [Power Plant](#) (8)
- » [Pre-School Campus](#) (2)
- » [Prison](#) (4)
- » [Private House](#) (2)
- » [Production Hall](#) (3)
- » [Public Art](#) (15)
- » [Public Housing](#) (1)
- » [Public Landscapes](#) (81)
- » [Public Restroom](#) (1)
- » [Railway Area](#) (1)
- » [Railway Station](#) (14)
- » [Recreational facility](#) (13)
- » [Rehabilitation Centre](#) (7)
- » [Rental house](#) (1)
- » [Research & Development Centre](#) (19)
- » [Research Station](#) (30)
- » [Residential](#) (736)
- » [Resort](#) (26)
- » [Resource Center](#) (2)
- » [Rest Stop](#) (1)
- » [Restaurant](#) (143)
- » [Restoration](#) (10)
- » [Retail](#) (20)
- » [Retail facilities](#) (17)
- » [Retirement Home](#) (9)
- » [Retreat](#) (5)
- » [riding arena](#) (1)
- » [Road](#) (2)
- » [Room](#) (10)
- » [S/W](#) (1691)
 - » [Adobe](#) (358)
 - » [Adobe CS](#) (41)
 - » [Illustrator](#) (102)
 - » [InDesign](#) (33)
 - » [LightRoom](#) (1)
 - » [Photoshop](#) (285)
 - » [AlphaCAM](#) (1)
 - » [Arc+](#) (1)
 - » [Artlantis](#) (36)
 - » [Autodesk](#) (1169)
 - » [3dS Max](#) (352)
 - » [Architectural Desktop](#) (1)
 - » [Autocad](#) (929)
 - » [Autodesk Inventor](#) (2)
 - » [Ecotect](#) (10)
 - » [Maya](#) (57)
 - » [Navisworks](#) (7)
 - » [Revit](#) (128)
 - » [Topcad](#) (2)
 - » [AutoDesSys](#) (31)
 - » [FormZ](#) (31)
 - » [Bentley](#) (51)

- » [Generative Components](#) (5)
- » [Microstation](#) (45)
- » [ProjectWise](#) (1)
- » [BricsCAD](#) (1)
- » [Cadpipe](#) (1)
- » [CYPE](#) (13)
- » [Dassault Systèmes](#) (3)
 - » [Catia](#) (3)
- » [Engineered Software](#) (5)
 - » [PowerCADD](#) (5)
- » [Google](#) (255)
 - » [SketchUp](#) (255)
- » [Graphisoft](#) (172)
 - » [ArchiCAD](#) (172)
- » [Grasshopper](#) (6)
- » [JWWCAD](#) (3)
- » [MAXON](#) (39)
 - » [Cinema 4D](#) (39)
- » [Maxwell](#) (28)
- » [McNeel](#) (312)
 - » [Rhino](#) (312)
- » [Mental Ray](#) (12)
- » [Nemetschek](#) (221)
 - » [AllPlan](#) (14)
 - » [Vectorworks](#) (206)
- » [Podium](#) (3)
- » [Rhinoceros](#) (10)
- » [sketch up](#) (7)
- » [T-Splines](#) (4)
- » [TEKLA](#) (4)
- » [TopSolid](#) (1)
- » [ZWCAD](#) (6)
- » [Safety Center](#) (1)
- » [Sailing Center](#) (1)
- » [Salon](#) (13)
- » [Sanctuary](#) (2)
- » [Sauna](#) (1)
- » [School](#) (194)
- » [Science Centre](#) (1)
- » [Science Club](#) (4)
- » [Science Park](#) (8)
- » [Sculpture](#) (3)
- » [SeaLand](#) (1)
- » [Selected Works](#) (2)
- » [Senior center](#) (5)
- » [Service Station](#) (11)
- » [Services Centre](#) (6)
- » [Sewing Atelier](#) (1)
- » [Shelter](#) (13)
- » [Shelter Home](#) (2)
- » [Shop](#) (66)
- » [shopping center](#) (5)
- » [Shopping Mall](#) (18)
- » [Showroom](#) (69)
- » [Skate Park](#) (1)
- » [Ski Jump Tower](#) (1)
- » [Skylight](#) (1)
- » [Skyscrapers](#) (9)
- » [Smoking room](#) (1)
- » [Society](#) (3)
- » [Social Centre](#) (18)
- » [Social welfare](#) (2)
- » [Solar Panel Factory](#) (4)
- » [Solar-Sail](#) (1)
- » [Solid Waste Management Centre](#) (1)
- » [Spa Centre](#) (11)
- » [space](#) (2)
- » [Spaceport](#) (2)
- » [Sports Centre](#) (9)
- » [Sports Complex](#) (54)
- » [Sports Hall](#) (25)
- » [Stadium](#) (42)
- » [Staircase](#) (4)
- » [Station](#) (14)
- » [Stock Exchange](#) (3)
- » [Stores](#) (40)
- » [Street](#) (1)
- » [Streetscape](#) (1)
- » [Student Center](#) (6)
- » [Studio](#) (60)
- » [Super Market](#) (3)
- » [Sustainable Design](#) (44)
- » [Swimming Pool](#) (22)
- » [Table](#) (2)
- » [Table Lamp](#) (1)
- » [Teahouse](#) (1)

- » [Technological Park](#) (8)
- » [Technology](#) (1)
- » [Temple](#) (4)
- » [Temporary Housing](#) (1)
- » [Terminal](#) (4)
- » [Terrace](#) (6)
- » [Theater](#) (50)
- » [Toilet](#) (4)
- » [Tourism Office](#) (1)
- » [Tourist Route](#) (2)
- » [Tower](#) (161)
- » [Tower Skin](#) (2)
- » [town](#) (4)
- » [Town centre](#) (2)
- » [Town Hall](#) (5)
- » [Track](#) (4)
- » [Trade Fair Centre](#) (4)
- » [Traffic Circle](#) (1)
- » [Train Station](#) (5)
- » [Training centre](#) (6)
- » [Transmitting](#) (1)
- » [Transport & Infrastructure](#) (11)
- » [Transport Center](#) (1)
- » [Tsunami Disaster Prevention Station](#) (1)
- » [Tunnel](#) (3)
- » [Uncategorized](#) (176)
- » [University Building](#) (84)
- » [Urban Design](#) (85)
- » [V-Ray](#) (91)
- » [valley station](#) (2)
- » [Villa](#) (92)
- » [Village](#) (3)
- » [Visitor Center](#) (11)
- » [Wall Art](#) (2)
- » [Warehouse](#) (22)
- » [Waste Treatment Facility](#) (1)
- » [Water Park](#) (5)
- » [Water tank](#) (2)
- » [Water treatment Plant](#) (4)
- » [Wedding Chapel](#) (2)
- » [Wedding dress](#) (1)
- » [Wellness Center](#) (2)
- » [Wildlife Center](#) (3)
- » [Windmill](#) (2)
- » [Wine Shop](#) (1)
- » [Wine Shops](#) (2)
- » [Winery](#) (18)
- » [Workshop](#) (10)
- » [Youth Centre](#) (3)
- » [Zoo](#) (2)
- » [Zoological Park](#) (7)

Meta

- » [Log in](#)
- » [Entries RSS](#)
- » [Comments RSS](#)

»

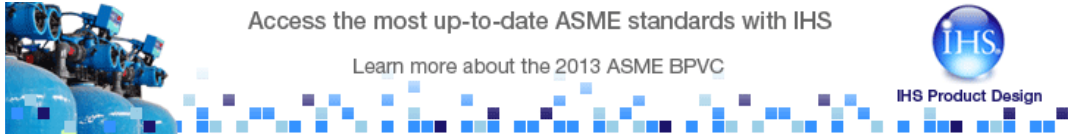

Access the most up-to-date ASME standards with IHS

Learn more about the 2013 ASME BPVC



IHS Product Design

The banner features a blue and white pixelated graphic background. On the left, there is a small image of industrial machinery. The text is centered, and the IHS logo is on the right.



© 2013 Internet Business Systems, Inc.
595 Millich Dr., Suite 210, Campbell, CA 95008
+1 (408) 850-9202 — [Contact Us](#), or visit our other sites:
[TechJobsCafe](#) [EDACafe](#) [GISCafe](#) [MCADCAfe](#) [NanoTechCafe](#) [ShareC@](#)
[Privacy Policy](#)